

ENDCAP WITH DRIVE-THRU AVAILABLE

NWC Lake Mead Parkway & Basic Road | Henderson, NV 89015



AVAILABLE SF ±1,800 SF
RATES Contact Agent



PROPERTY HIGHLIGHTS

- End Cap with Drive Thru ±1,800 SF, includes grease interceptor
- Target Anchored Center, Join Ulta Beauty, Petsmart, Big Lots, Marshalls and Ross

CO-TENANTS



2021 DEMOGRAPHIC SNAPSHOT

| | | |
|---|--|-------------------|
|  | Population: 3-mile radius | 97,513 |
|  | Average HH Income: | \$85,212 |
|  | Traffic Counts: W Lake Mead Pkwy | 45,575 vpd |



Contact: Terry L. Hamilton, CCIM • c: 702.340.9597 • o: 702.954.3901 • thamilton@newmarketadvisors.com
Melissa Campanella, CCIM • c: 702.743.1967 • o: 702.954.3904 • mcampanella@newmarketadvisors.com



5245 South Durango Drive • Las Vegas, Nevada 89113 • newmarketadvisors.com

NewMarket Advisors

ENDCAP WITH DRIVE-THRU AVAILABLE

NWC Lake Mead Parkway & Basic Road | Henderson, NV 89015



Contact: Terry L. Hamilton, CCIM • c: 702.340.9597 • o: 702.954.3901 • thamilton@newmarketadvisors.com
 Melissa Campanella, CCIM • c: 702.743.1967 • o: 702.954.3904 • mcampanella@newmarketadvisors.com



5245 South Durango Drive • Las Vegas, Nevada 89113 • newmarketadvisors.com

NewMarket Advisors

The information contained herein has been given to us by the owner of the property or other sources deemed reliable. We have no reason to doubt its accuracy, but we do not guarantee it. All information should be verified prior to purchase or lease. Site plan subject to change without prior notice.

License: Terry Hamilton, NV S.0060856.PC
 Melissa Campanella, NV S.0054328.LLC

ENDCAP WITH DRIVE-THRU AVAILABLE

NWC Lake Mead Parkway & Basic Road | Henderson, NV 89015

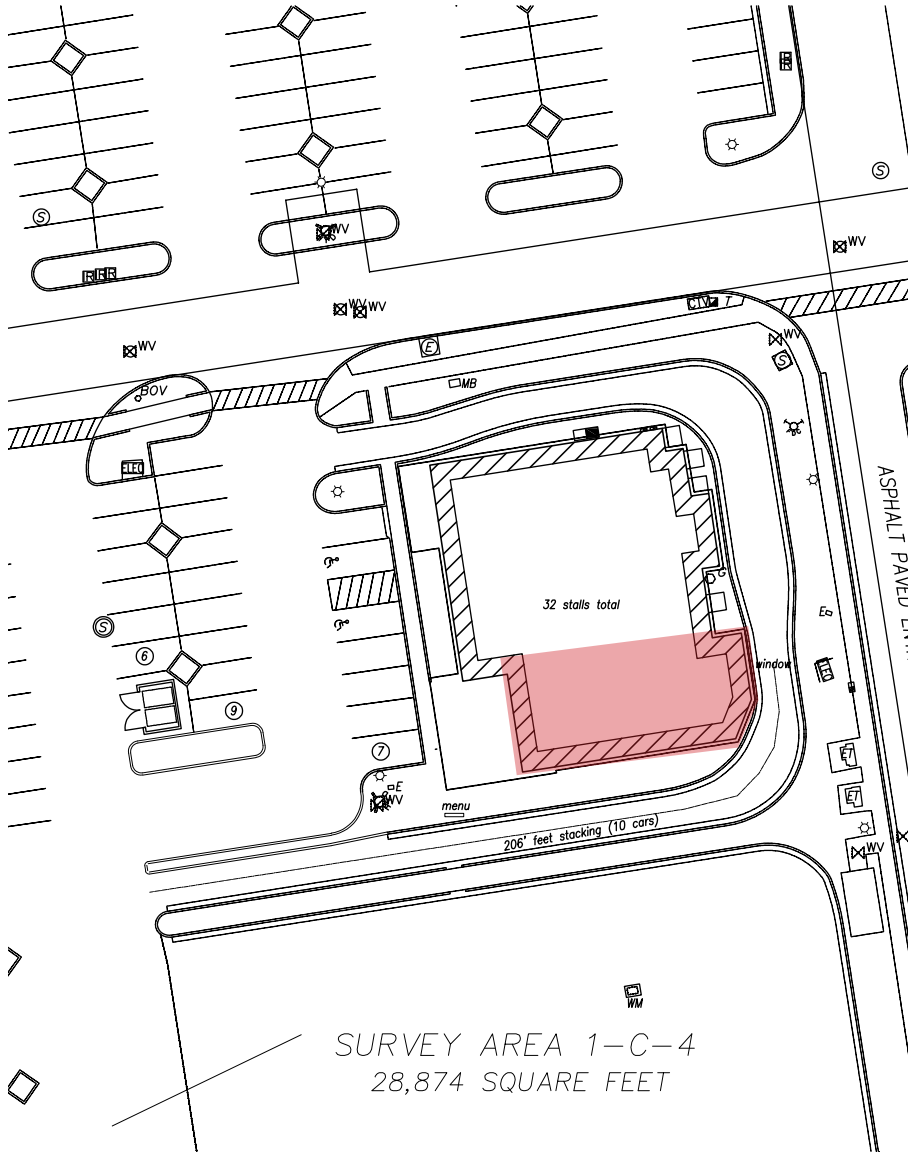
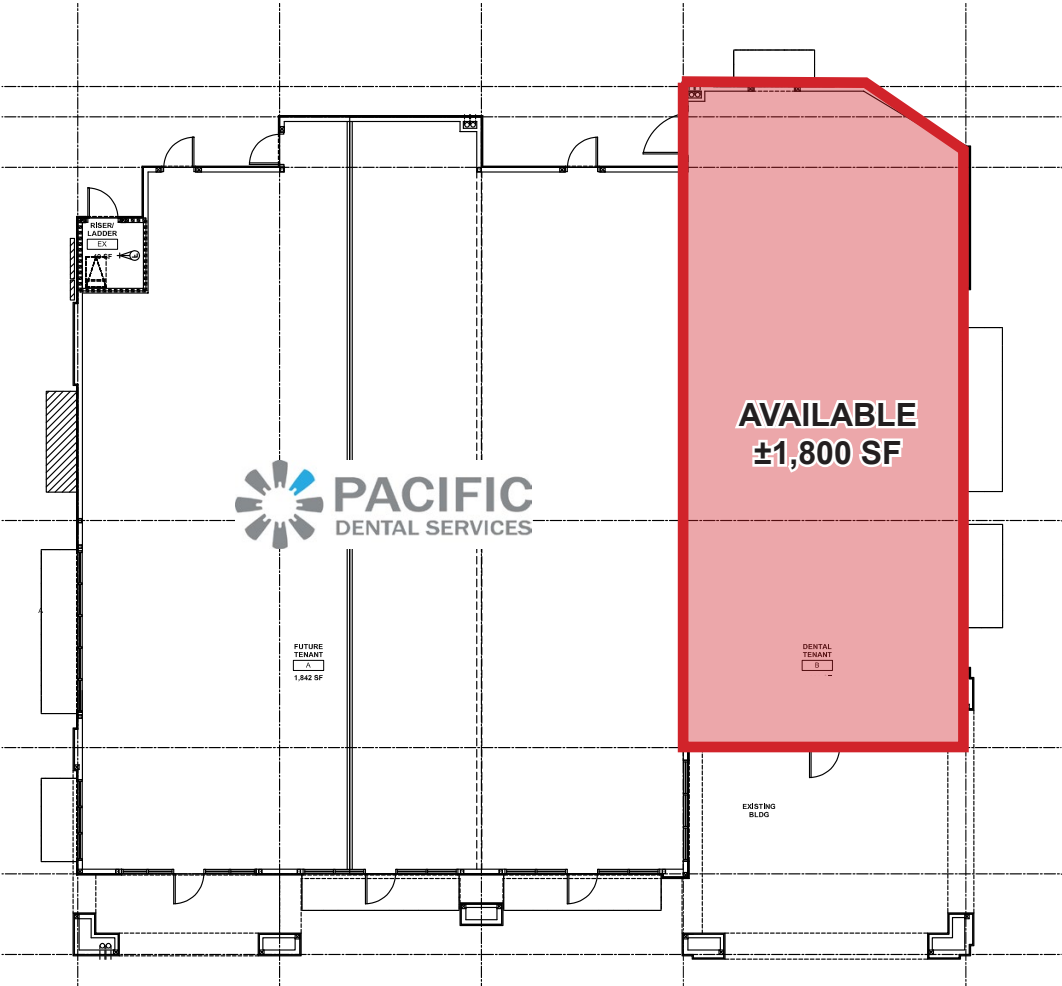

Contact: Terry L. Hamilton, CCIM • c: 702.340.9597 • o: 702.954.3901 • thamilton@newmarketadvisors.com
 Melissa Campanella, CCIM • c: 702.743.1967 • o: 702.954.3904 • mcampanella@newmarketadvisors.com



5245 South Durango Drive • Las Vegas, Nevada 89113 • newmarketadvisors.com

NewMarket Advisors

The information contained herein has been given to us by the owner of the property or other sources deemed reliable. We have no reason to doubt its accuracy, but we do not guarantee it. All information should be verified prior to purchase or lease. Site plan subject to change without prior notice.

License: Terry Hamilton, NV S.0060856.PC
 Melissa Campanella, NV S.0054328.LLC

September 14, 2022



Contact: Terry L. Hamilton, CCIM • c: 702.340.9597 • o: 702.954.3901 • thamilton@newmarketadvisors.com
 Melissa Campanella, CCIM • c: 702.743.1967 • o: 702.954.3904 • mcampanella@newmarketadvisors.com



5245 South Durango Drive • Las Vegas, Nevada 89113 • newmarketadvisors.com

NewMarket Advisors

ENDCAP WITH DRIVE-THRU AVAILABLE

NWC Lake Mead Parkway & Basic Road | Henderson, NV 89015

2021 ESTIMATED DEMOGRAPHICS



Population

| | |
|--------|----------------|
| 1-Mile | 6,938 |
| 3-Mile | 97,513 |
| 5-Mile | 227,016 |



Average Household Income

| | |
|--------|-----------------|
| 1-Mile | \$62,288 |
| 3-Mile | \$85,212 |
| 5-Mile | \$91,392 |



Number of Households

| | |
|--------|---------------|
| 1-Mile | 2,727 |
| 3-Mile | 36,874 |
| 5-Mile | 86,879 |



Daytime Population (Employees)

| | |
|--------|---------------|
| 1-Mile | 5,383 |
| 3-Mile | 31,153 |
| 5-Mile | 60,823 |

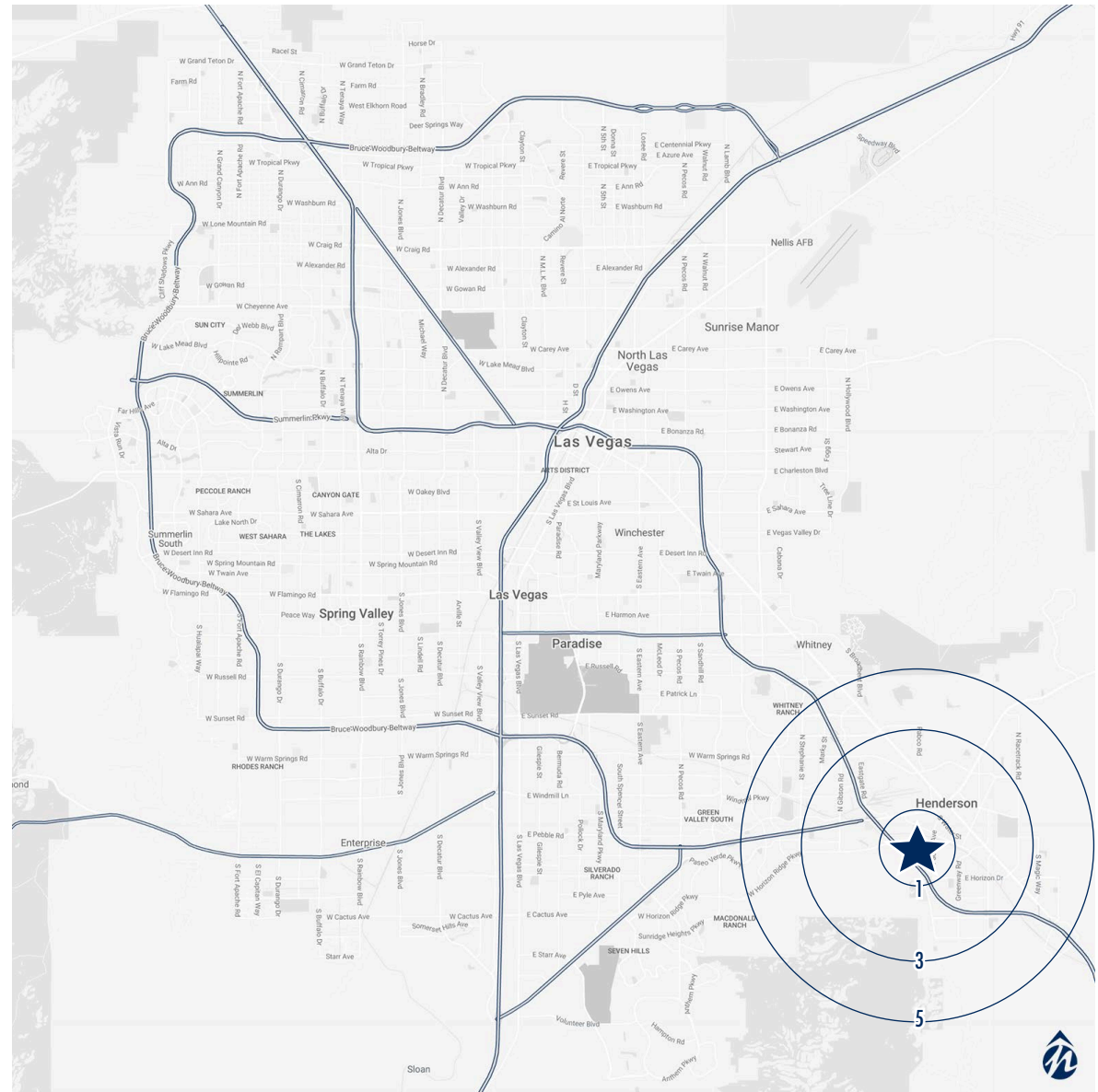

Contact: Terry L. Hamilton, CCIM • c: 702.340.9597 • o: 702.954.3901 • thamilton@newmarketadvisors.com
 Melissa Campanella, CCIM • c: 702.743.1967 • o: 702.954.3904 • mcampanella@newmarketadvisors.com



5245 South Durango Drive • Las Vegas, Nevada 89113 • newmarketadvisors.com

NewMarket Advisors