

JOIN DAVE & BUSTER'S

NEC Galleria Drive & Stufflebeam | Henderson, NV 89011



AVAILABLE SF Up to ±5,000 SF
ZONING C- "Commercial"
RATES Contact Agent
APN 161-13-481-015

PROPERTY HIGHLIGHTS

- Ready for tenant improvements
- Up to ±5,000 SF remaining next to Roll-Em-Up Taquitos
- 991 SF Space Next to Starbucks

NEARBY TENANTS



DRONE FOOTAGE

Click here for Drone Video:

LINK: https://youtu.be/Uke9x9Gx5_c



Traffic Counts:

I-95 & Galleria

Galleria

134,000 vpd
28,700 vpd



Contact:

Terry L. Hamilton, CCIM • c: 702.340.9597 • o: 702.954.3901 • thamilton@newmarketadvisors.com

Melissa Campanella, CCIM • c: 702.743.1967 • o: 702.954.3904 • mcampanella@newmarketadvisors.com



5245 South Durango Drive • Las Vegas, Nevada 89113 • newmarketadvisors.com

NewMarket Advisors



Contact: Terry L. Hamilton, CCIM • c: 702.340.9597 • o: 702.954.3901 • thamilton@newmarketadvisors.com
Melissa Campanella, CCIM • c: 702.743.1967 • o: 702.954.3904 • mcampanella@newmarketadvisors.com



CHAINLINKS
RETAIL ADVISORS

5245 South Durango Drive • Las Vegas, Nevada 89113 • newmarketadvisors.com

Site	SQ FT	Use
Pad 1	4,300 SF	In Escrow - TBD
Pad 2	4,300 SF	In Escrow - TBD
Lot 5	2.10 Acres	Cracker Barrel (NAP)
Lot 6	7,000 SF	NAP
Pad B	991 SF	Available
Pad C2	5,000 SF	Available
Pad D	1,800 SF	Available
Pad E	3,000 SF	KinderCare
Parcel 5	4.5 Acres	Dave & Buster's

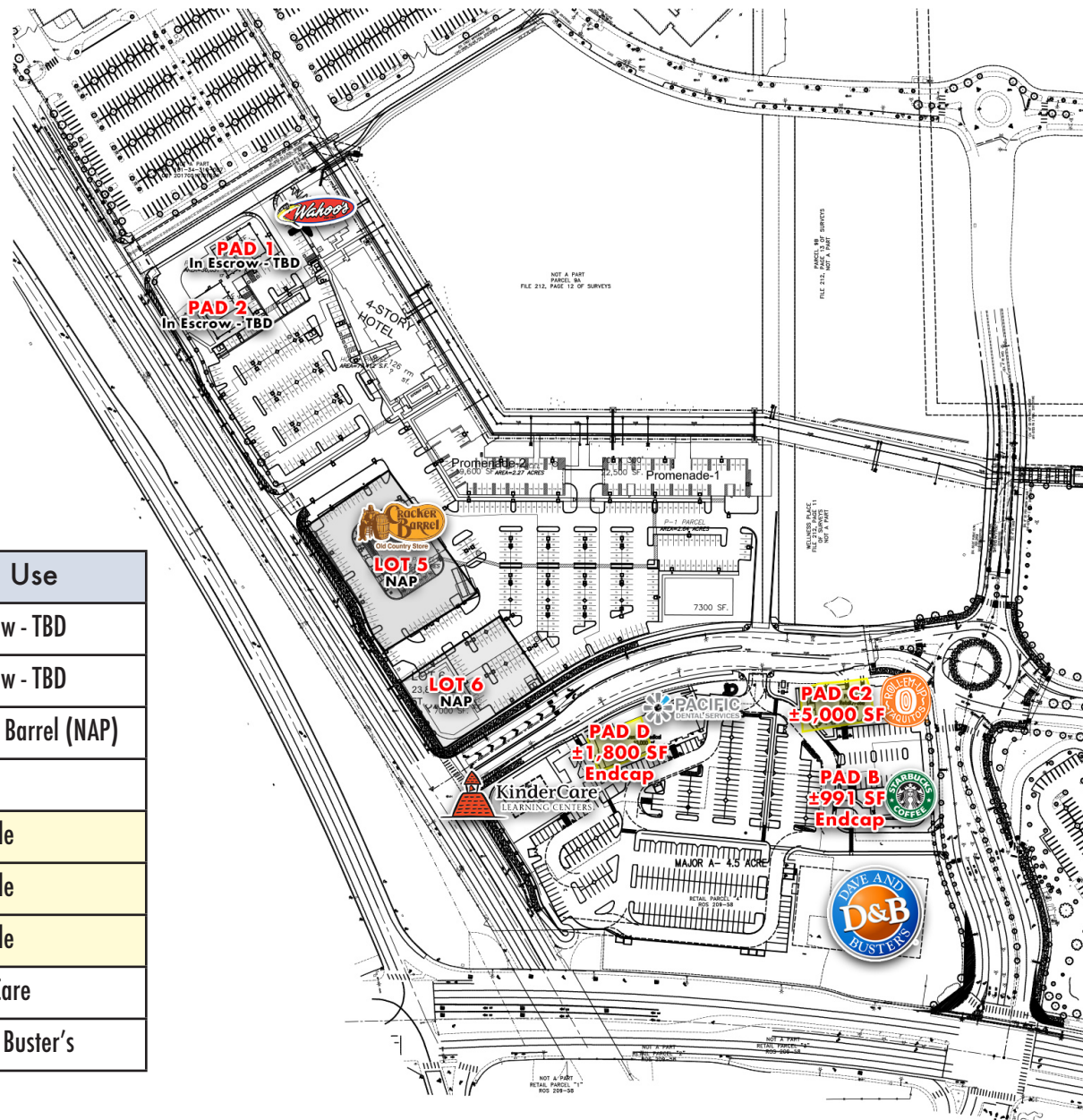

Contact:

Terry L. Hamilton, CCIM • c: 702.340.9597 • o: 702.954.3901 • thamilton@newmarketadvisors.com

Melissa Campanella, CCIM • c: 702.743.1967 • o: 702.954.3904 • mcampanella@newmarketadvisors.com



5245 South Durango Drive • Las Vegas, Nevada 89113 • newmarketadvisors.com

NewMarket Advisors

JOIN DAVE & BUSTER’S AT UNION VILLAGE

NEC Galleria Drive & Stuffebeam | Henderson, NV 89011



Contact: Terry L. Hamilton, CCIM • c: 702.340.9597 • o: 702.954.3901 • thamilton@newmarketadvisors.com
Melissa Campanella, CCIM • c: 702.743.1967 • o: 702.954.3904 • mcampanella@newmarketadvisors.com



5245 South Durango Drive • Las Vegas, Nevada 89113 • newmarketadvisors.com NewMarket Advisors

JOIN DAVE & BUSTER'S AT UNION VILLAGE

NEC Galleria Drive & Stuffebeam | Henderson, NV 89011



Contact: Terry L. Hamilton, CCIM • c: 702.340.9597 • o: 702.954.3901 • thamilton@newmarketadvisors.com
Melissa Campanella, CCIM • c: 702.743.1967 • o: 702.954.3904 • mcampanella@newmarketadvisors.com



5245 South Durango Drive • Las Vegas, Nevada 89113 • newmarketadvisors.com NewMarket Advisors

JOIN DAVE & BUSTER'S AT UNION VILLAGE

NEC Galleria Drive & Stuffebeam | Henderson, NV 89011

2022 ESTIMATED DEMOGRAPHICS



Population

1-Mile	15,001
3-Mile	121,798
5-Mile	320,586



Average Household Income

1-Mile	\$60,134
3-Mile	\$74,060
5-Mile	\$82,762



Number of Households

1-Mile	5,996
3-Mile	47,448
5-Mile	125,467



Daytime Population (Employees)

1-Mile	11,366
3-Mile	42,495
5-Mile	107,211



Traffic Counts: **134,000 vpd**
I-95 & Galleria

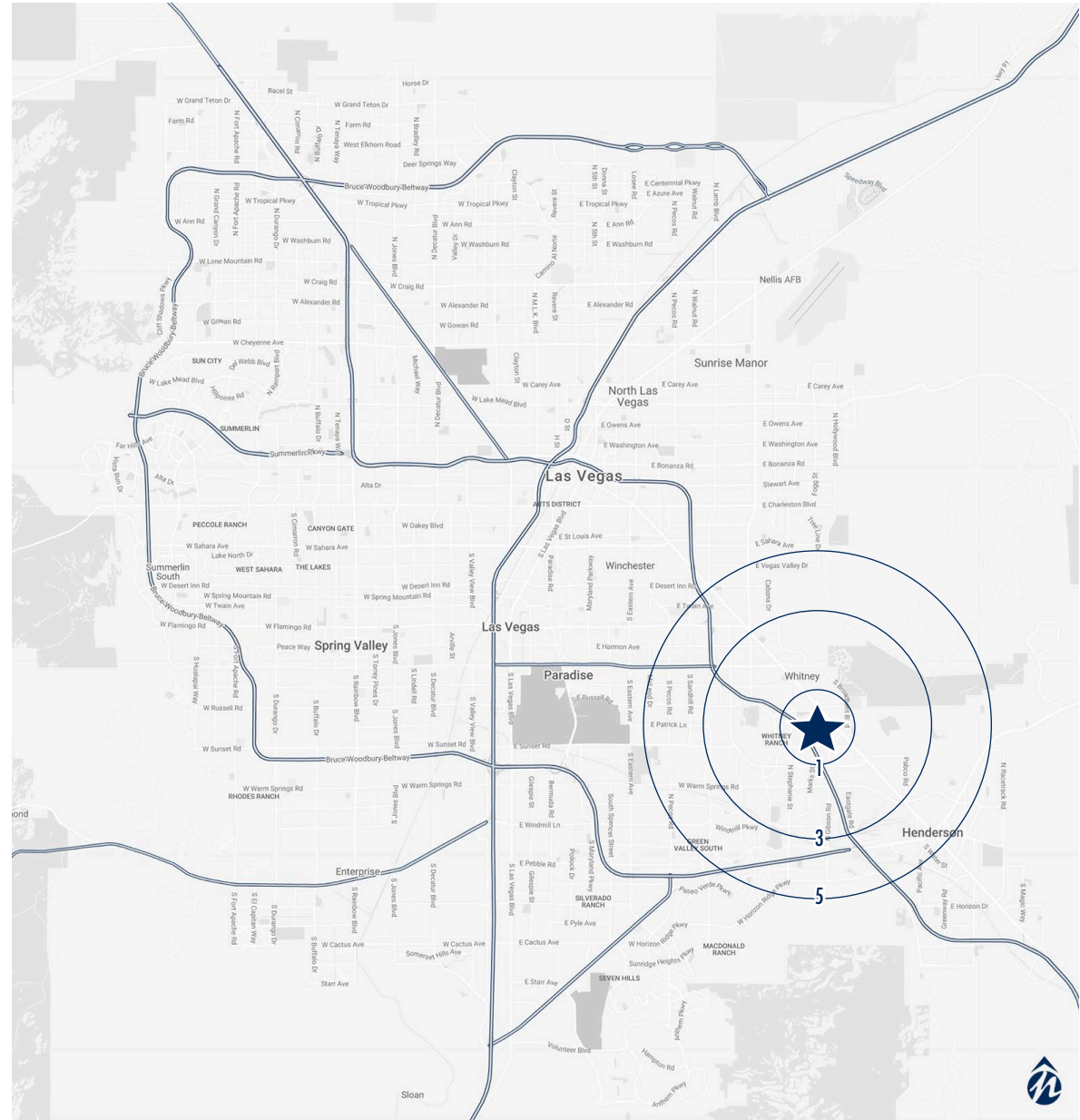

Contact:

Terry L. Hamilton, CCIM • c: 702.340.9597 • o: 702.954.3901 • thamilton@newmarketadvisors.com

Melissa Campanella, CCIM • c: 702.743.1967 • o: 702.954.3904 • mcampanella@newmarketadvisors.com



5245 South Durango Drive • Las Vegas, Nevada 89113 • newmarketadvisors.com

NewMarket Advisors