



COVENANT  
REAL ESTATE GROUP

Target Outparcel  
Opportunity

SWQ E. FOURTH ST. &  
MILLIKEN AVE.



RETAIL FOR  
LEASE

**SWQ E. Fourth St. &  
Milliken Ave.**

# Ontario

**1 mile** ▼

**5,880**

Total Population

**21,656**

Daytime Population

**\$72,992**

Avg HH Income

**3 miles** ▼

**58,491**

Total Population

**113,819**

Daytime Population

**\$88,150**

Avg HH Income

**5 miles** ▼

**304,521**

Total Population

**349,344**

Daytime Population

**\$93,708**

Avg HH Income

## PROPERTY HIGHLIGHTS

# 01.

**Available:**

**Suite B-1,092 SF**

- Single Tenant Opportunity
- Within one block of Ontario Mills-the largest shopping center in San Bernardino County
- Anchor tenants include: Target, PetSmart, DSW & Big Al's
- Adjacent to ±6,000 existing/under construction residential units within the immediate trade area

## AREA RETAILERS



# SPACE PLAN

# 02.

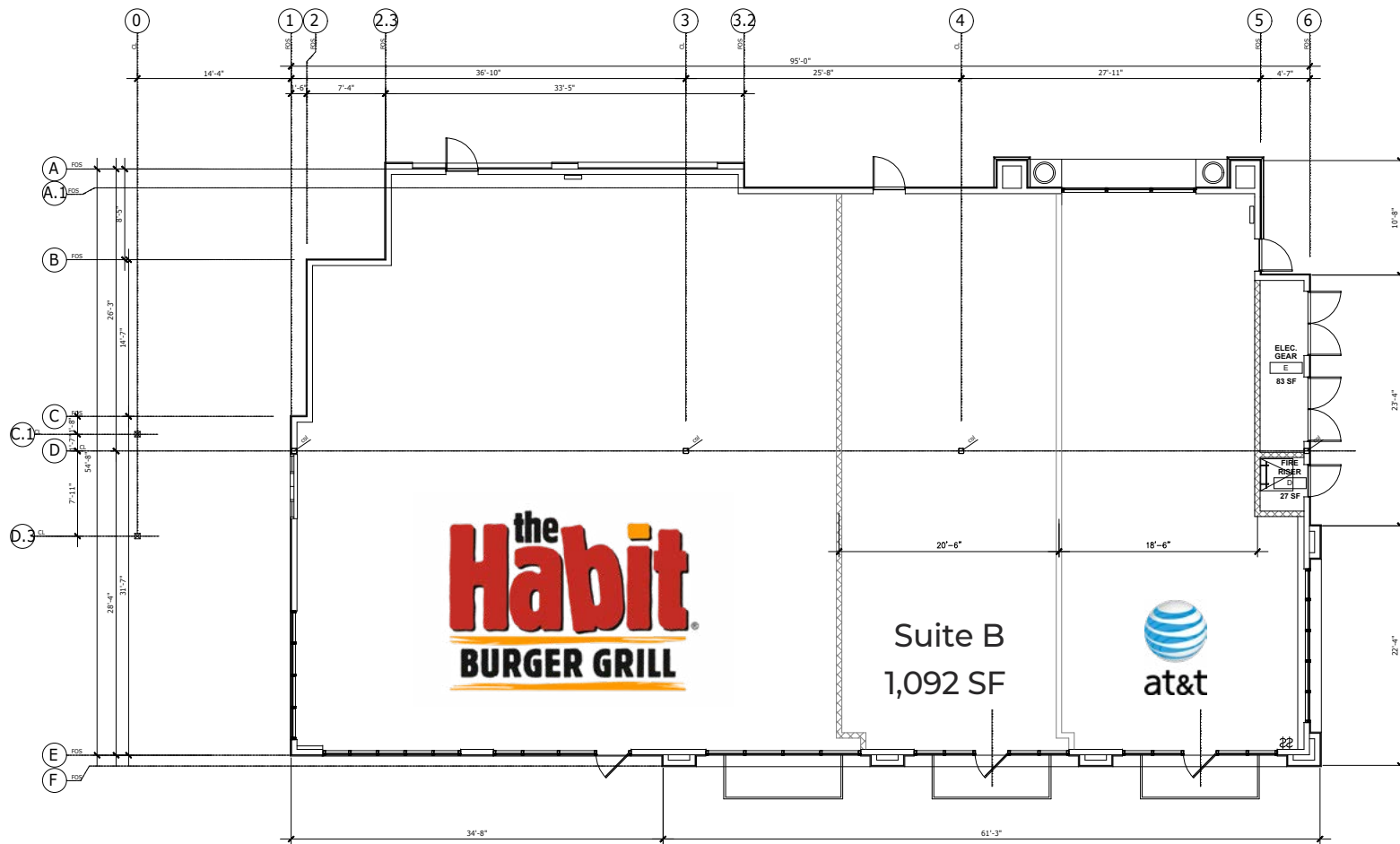

# SITE PLAN

# 03.



# AERIAL 04.





COVENANT  
REAL ESTATE GROUP 

The icon for Covenant Real Estate Group is a stylized blue graphic of three vertical bars of increasing height, resembling a bar chart or a modern building facade.

Contact Us:

**Blake Kaplan**

Executive Vice President  
License #02001158  
Tel: 1 909 702 3367  
Blake.Kaplan@am.jll.com

**Drew Olson**

Associate  
License #02051219  
Tel: 1 949 870 0565  
Drew.Olson@am.jll.com

**Erik Westedt**

Managing Director  
License #01372758  
Erik.Westedt@am.jll.com

Target Outparcel  
Opportunity