

SPACE FOR LEASE

950 West Baptist Road

MONUMENT, CO 80132

RETAIL

BRAND NEW CONSTRUCTION!



SPACE FOR LEASE

JACKSON CREEK MARKET VILLAGE

- + 1,994 SF space is available and would be perfect for a future restaurant or medical office.
- + Situated on West Baptist Road just past the light at Jackson Creek Parkway with ample parking and gorgeous mountain views.
- + Property is located adjacent to King Soopers anchored shopping center.

Property Details

NNN Estimate	\$8.69/PSF
Lease Rate	\$32.00/PSF
Building Size	4,991 SF
Space Available	1,994 SF

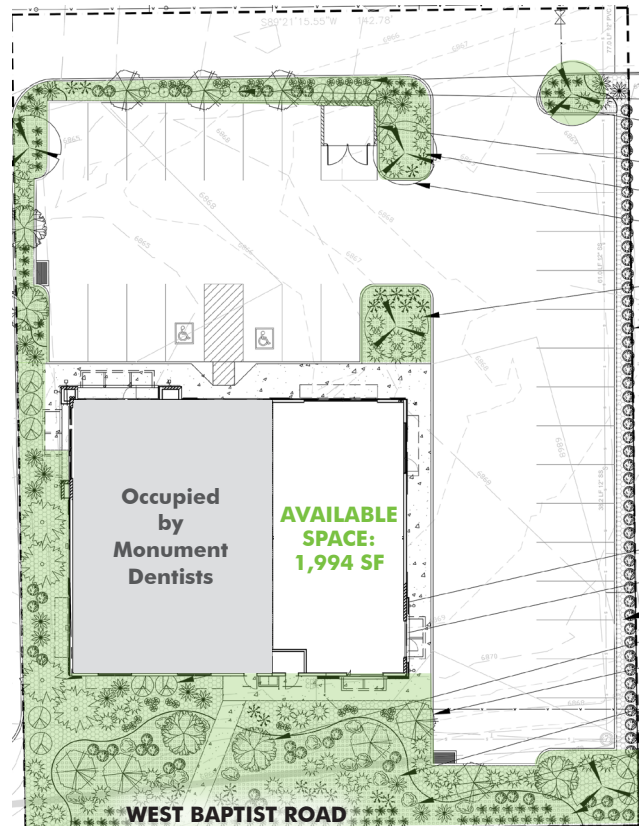

SPACE FOR LEASE

950 West Baptist Road

MONUMENT, CO 80132

RETAIL



Traffic Counts

West Baptist Road at Jackson Creek Parkway	10,595 VPD
East Baptist Road at West Baptist Road	9,373 VPD

2018 Estimated Demographics

	1 mile	3 miles	5 miles
Population	5,609	25,837	54,295
Average Household Income	\$164,674	\$146,125	\$146,077
Households	1,709	8,717	17,119

CONTACT

Dan Rodriguez

Senior Associate
 +1 719 471 6046
 dan.rodriguez@cbre.com

© 2019 CBRE, Inc. All rights reserved. This information has been obtained from sources believed reliable, but has not been verified for accuracy or completeness. You should conduct a careful, independent investigation of the property and verify all information. Any reliance on this information is solely at your own risk. CBRE and the CBRE logo are service marks of CBRE, Inc. All other marks displayed on this document are the property of their respective owners. Photos herein are the property of their respective owners. Use of these images without the express written consent of the owner is prohibited.